



serie **TRX**

TRINCIATUTTO ALL MULCHER TRX

La TRX è una trinciatrice universale concepita e costruita per eseguire molteplici lavori.

The TRX is a universal shredder designed and built for different uses.

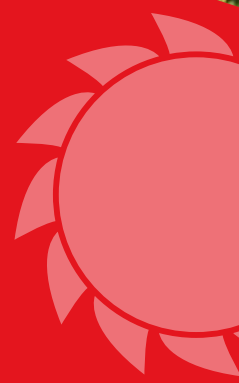

Via Corato SP 238 – Contrada Polisciazzo
70022 Altamura (BA) - ITALY
(+39) 080 314 05 44 - (+39) 334 12 51 509
info@crushingtech.com

WWW.CRUSHINGTECH.COM



CRUSHINGTECH
STONES & FORESTRY MACHINES

MADE IN ITALY

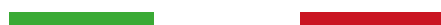

serie **TRX**

TRINCIATUTTO ALL MULCHER TRX



UTILITÀ UTILITY

- 01** Frantuma il terreno superficiale con sassi e roccia affiorante, cespugli, potature, sottoboschi, aree di servizio
Shredding superficial soil with stones and rock, bushes, pruning, undergrowth, service areas
- 02** Prepara letti di semina
Prepare seed beds
- 03** Trasmissione a cinghie
Belt transmission



DETTAGLI TECNICI TECHNICAL DETAILS

ALLESTIMENTO STANDARD

- ✓ Rotore a picchi ϕ 22 mm Fig.1
- ✓ D = Doppia trasmissione a cinghie
- ✓ Griglia posteriore in **Hardox** regolabile idraulicamente tramite il distributore del trattore
- ✓ Le slitte possono essere regolate in altezza
- ✓ Tutte le parti di usura a diretto contatto con sassi e terra sono in Hardox e intercambiabili
- ✓ Albero cardano con bullone di sicurezza

STANDARD EQUIPMENT

- ✓ Rotor with peaks ϕ 22 mm Fig.1
- ✓ Double belts transmission
- ✓ Rear grate in **Hardox** adjustable by the distributor of tractor
- ✓ Side skids adjustable in height
- ✓ All the wearing parts in direct contact with ground are in Hardox and interchangeable
- ✓ Drive shaft with safety bolt

TRATTORE RICHIESTO

- ✓ Con superiduttore di velocità o cambio **VARIO**

TRACTOR

- ✓ *Creep CVT continuously variable transmission*

RICAMBI

- ✓ Picco ϕ 22 mm
- ✓ Rondella
- ✓ Rondella a molla

SPARE PARTS

- ✓ peak ϕ 22 mm
- ✓ washer
- ✓ spring washer

OPZIONI

- ✓ Per un maggiore uso **forestale** è possibile ordinare la macchina con rotore ad **Utensili a Martelli Fig.2**
- ✓ Utensile a Martello
- ✓ Bullone

OPTION

- ✓ For a major **forestal** use it is possible to order the machine with **Hammers Fig.2**
- ✓ Hammer tools
- ✓ Bolt

Fig.1

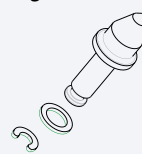
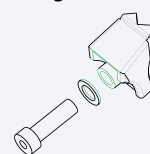
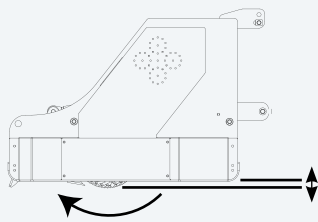

Fig.2





LAVORO WORK







40 mm profondità di lavoro circa
40 mm working depth approx

200 mm su terreno prelaborato circa
200 mm on pre worked ground approx

Trattore: con super riduttore o CVT vario
Tractor: creeper or CVT vario

SPECIFICHE TECNICHE TECHNICAL SPECIFICATIONS

MODELLO Model	 HP	PREZZO Price euro	 KG	LARGHEZZA LAVORO Working width mm	LARGHEZZA TOTALE Total width mm	PTO RPM	PICCO ø 22 mm  QNT	UTENSILE A MARTELLO  QNT
TRX-80	50 / 60		590	800	1100	540	45	
TRX-100	60 / 70		700	1000	1300	540	57	
TRX-120	70 / 80		850	1200	1500	540	69	
TRX-140	80 / 90		1100	1400	1730	540	93	
TRX-160	90 / 100		1200	1600	1900	540	105	
TRX-180	100 / 110		1320	1800	2100	540	117	



LAVORO WORK

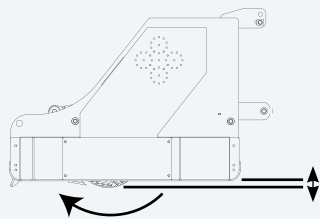



40 mm profondità di lavoro circa
40 mm working depth approx

200 mm su terreno prelaborato circa
200 mm on pre worked ground approx

Trattore: con super riduttore o CVT vario
Tractor: creeper or CVT vario

D = Doppia trasmissione laterale
D = Double lateral transmission

SPECIFICHE TECNICHE TECHNICAL SPECIFICATIONS

MODELLO Model	 HP	PREZZO Price euro	 KG	LARGHEZZA LAVORO Working width mm	LARGHEZZA TOTALE Total width mm	PTO RPM	PICCO ø 25 mm QNT 	UTENSILE A MARTELLO QNT 
TRXD-160	90 / 100		1350	1600	2000	1000	105	
TRXD-180	100 / 110		1450	1800	2200	1000	117	
TRXD-200	130 / 140		1900	2000	2460	1000	129	
TRXD-220	140 / 160		2050	2200	2700	1000	141	
TRXD-240	160 / 180		2200	2400	2900	1000	153	
TRXD-260	180 / 200		2400	2600	2900	1000	165	